



Benner-Nawman, Inc.

3450 Sabin Brown Road • Wickenburg, AZ 85390

(800) 992-3833 • (928) 684-2813 • www.bnproducts.com

Specification Sheet

Part #
14244W-IDW

*This Cabinet Measures:
14" Wide x 24" Tall x 4" Deep*

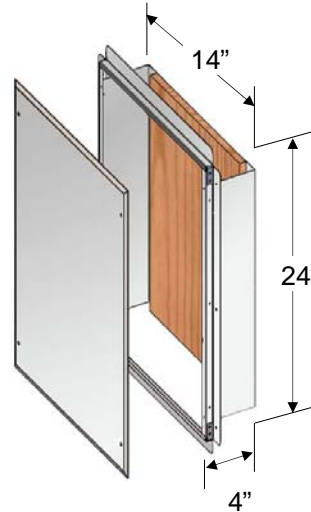

Features & Info:

- Includes a 1/2" plywood backboard for easy mounting of utility equipment
- The lid is fastened with 4 zinc-coated Phillips head sheet metal screws
- Made of 20-gauge galvaneal steel with a powder coat white finish
- Enclosure mounts prior to drywall between 16" center studs
- Lid comes blank w/ powder coat white finish
- Open top and bottom to the inside wall
- UL-Listed (UL1863)
- Box weight: 16 lbs.

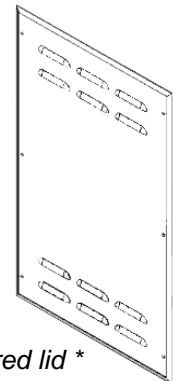

*Also available with a louvered lid **

Bottom View

